

ΩmegaPost

IMPACT recovery SYSTEMS™



**NTPEP
TESTED
200+
IMPACTS
AT 70
MPH**

BEST HIGH SPEED MANAGED LANE SOLUTION

- No fasteners to corrode
- Simple installation and replacement
- Durable, high speed performance
 - Heavy load crash tolerant
- Type V Super high intensity sheeting
- Ultraviolet light, ozone, and hydrocarbon resistant
 - 100% made in the USA
 - MUTCD compliant
- Category 1 Self Certified Device
 - Patent Pending



ΩmegaPost

PRODUCT SPECIFICATIONS



OmegaPost is a Category 1 small and light weight device with no attachments. Products such as these have been in common use for many years and are known to be crash worthy by testing of similar devices and years of demonstrable safe performance.

RECOMMENDED USES

Managed Lanes, HOV Lanes, Bike Lanes, Urban Restrictions, High Speed Traffic, Corrosive Environments

POST OPTIONS

Open top, Cap, or Long Squeeze

SHEETING COLORS

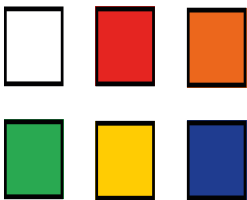

POST COLOR OPTIONS



BASE OPTIONS

OmegaPost™ can only be used with the Quarter Turn Surface Mount base in black (standard) or white/yellow



BASE REFLECTORS

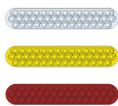

ΩmegaPost Delineator	Height	Post Diameter	Post Colors	Optional Sheeting	R. Sheeting Type	R. Sheeting Colors	Base Type
ΩmegaPost 2" Open Top	28" 36" 42"	2.375"	Yellow, Orange or White	Two 3" bands of reflective sheeting	Type V High Intensity Abrasion Resistant Sheeting	White, orange, yellow, red, green or blue	Surface Mount Quarter Turn Base

**Base and base mounting hardware is sold separately. Post spring type must be specified at time of order. ** Protective Bollard height is based on post height.*
**Open Top post is left with a smooth cut, open top*

TWO METHODS OF INSTALLATION:

1. ANCHOR KIT



2. EPOXY KIT - HIGH SPEED APPLICATION

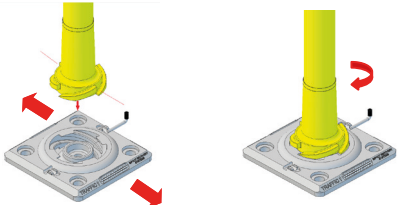

1. Insert the threaded post into base with holes aligned 90° to keeper pin slot.
2. Push down to insert the post and rotate clockwise until fully seated.

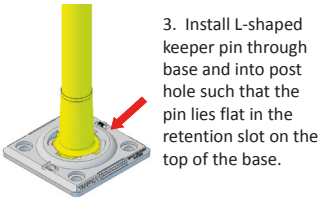

3. Install L-shaped keeper pin through base and into post hole such that the pin lies flat in the retention slot on the top of the base.

